

WT PROPRIETARY RELEASE SUBJECT TO CHANGE

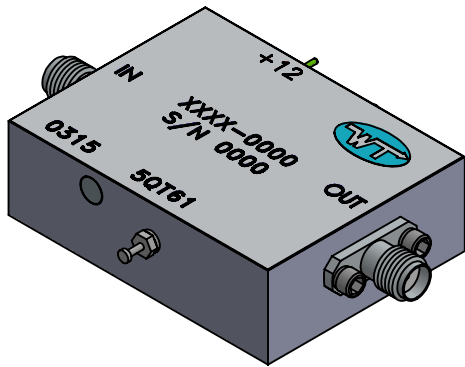
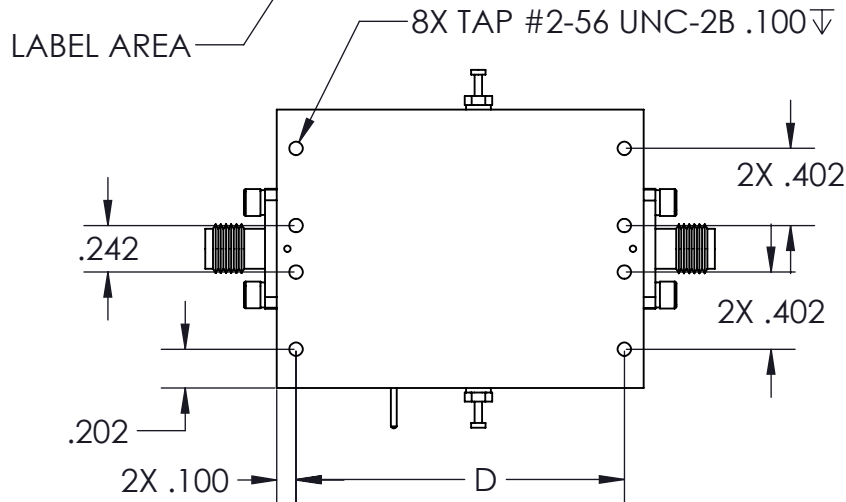
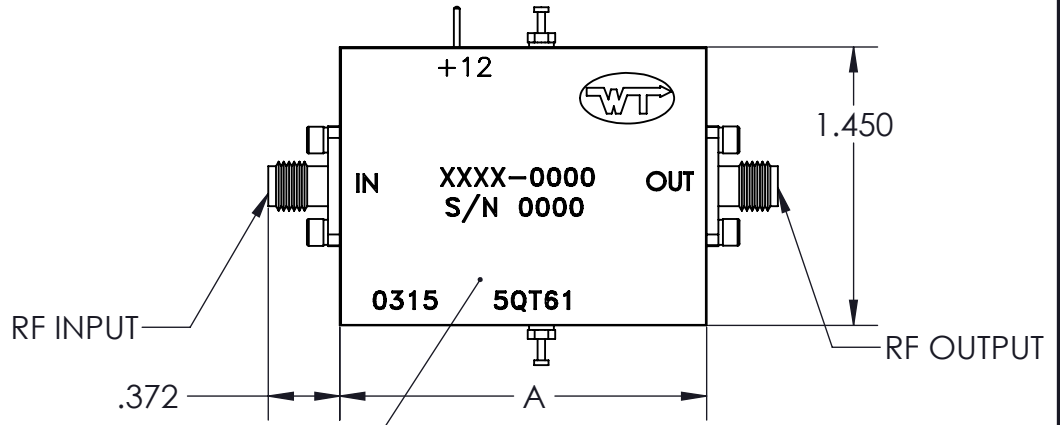
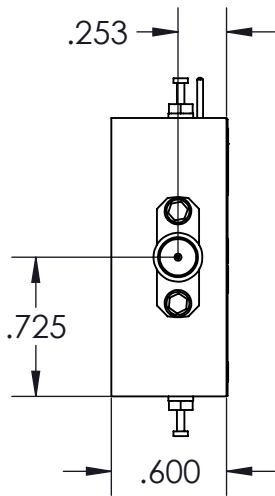
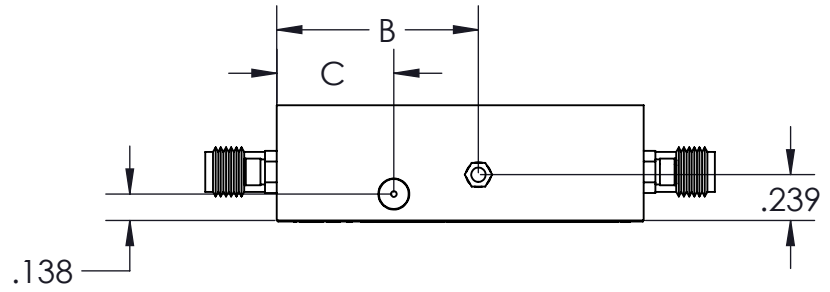

COAX CONNECTOR OPTIONS:
SMA, 2.9mm, 2.4mm

WAVEGUIDE OPTION AVAILABLE
UPON CUSTOMER REQUEST

APPLICATION NOTES:

- 1) ALL DIMENSION TOLERANCES ±.010 AFTER PLATING
- 2) RF MALE CONNECTORS ARE AVAILABLE UPON REQUEST
- 3) INTERPRET DRAWING PER ASME Y14.5M-1994

TYPE	A	B	C	D
3KK	1.710	.850	.410	1.510
4KK	1.910	1.050	.610	1.710
6KK	2.310	1.450	1.010	2.110

Wright Technologies Inc.

TITLE

WT PKD R13 SERIES