

WT PROPRIETARY RELEASE SUBJECT TO CHANGE

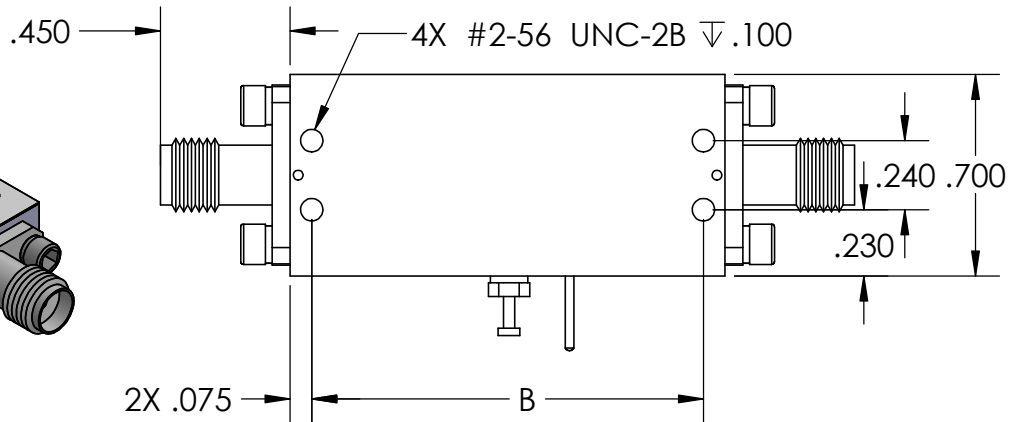
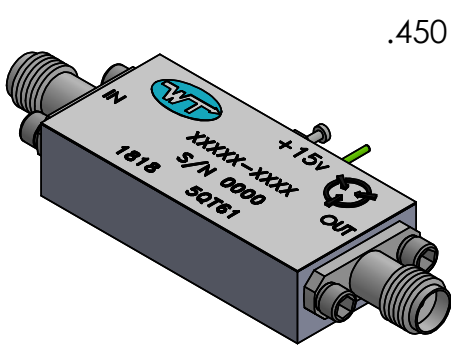
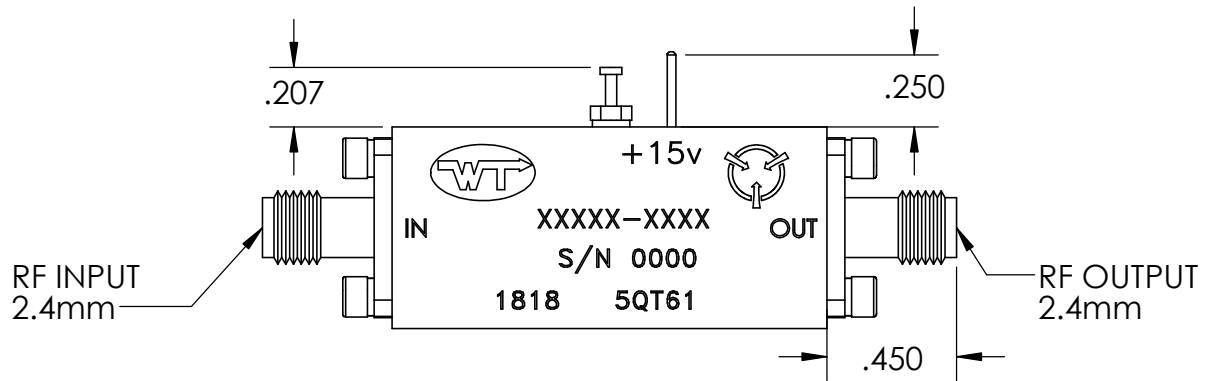
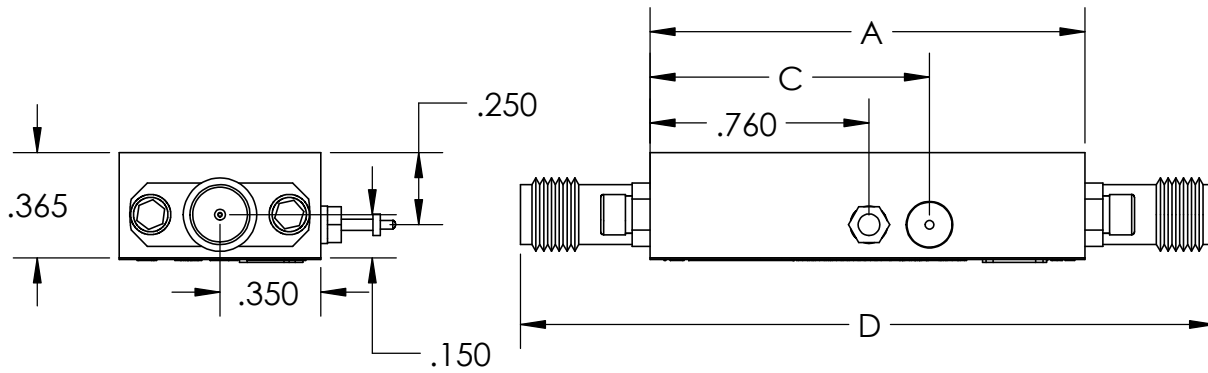

COAX CONNECTOR OPTIONS: 2.4mm
WAVEGUIDE OPTION AVAILABLE
UPON CUSTOMER REQUEST

APPLICATION NOTES:

UNLESS OTHERWISE SPECIFIED

1) ALL DIMENSION TOLERANCES

±.010 AFTER PLATING

2) STANDARD RF CONNECTORS ARE
FEMALE.

3) INTERPRET DRAWING PER ASME
Y14.5M-1994

TYPE	A	B	C	D
6VV	1.510	1.360	.970	2.410

Wright Technologies Inc.

TITLE

WT STANDARD SERIES, 6VV