

WT PROPRIETARY RELEASE SUBJECT TO CHANGE

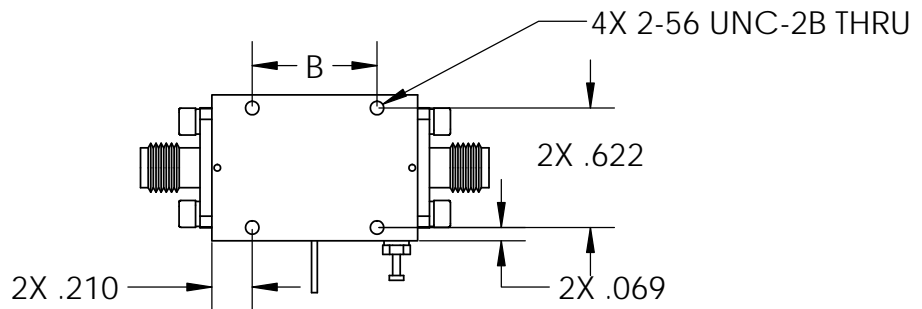
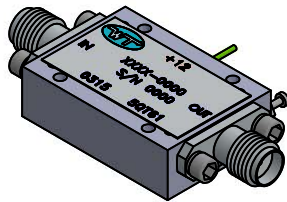
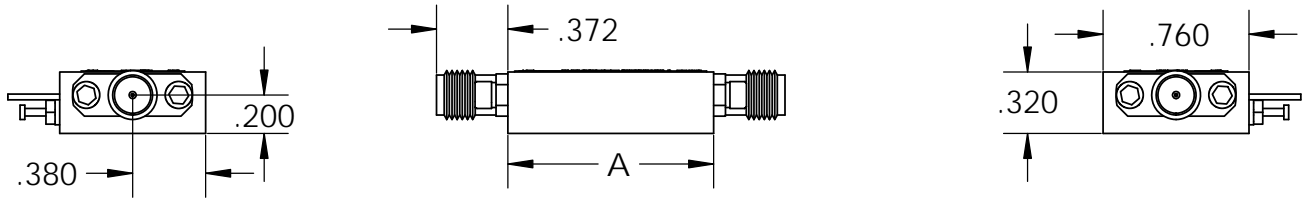
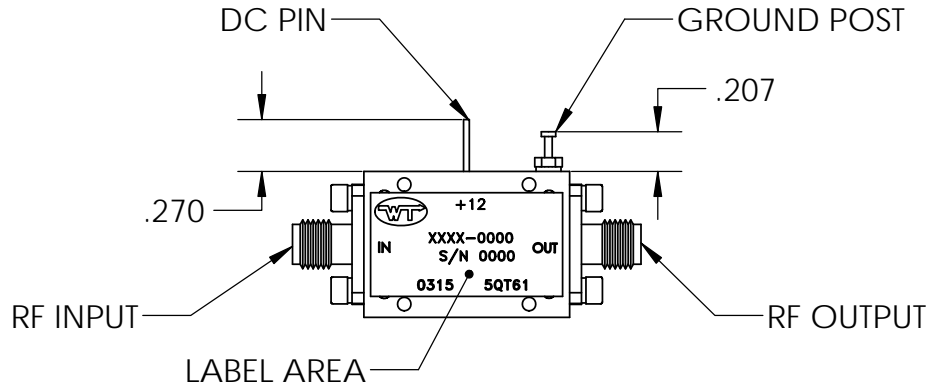
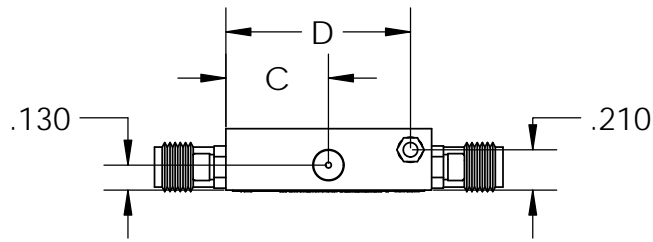

COAX CONNECTOR OPTIONS:
SMA, 2.9mm, 2.4mm

WAVEGUIDE OPTION AVAILABLE
UPON CUSTOMER REQUEST

APPLICATION NOTES:

- 1) ALL DIMENSION TOLERANCES $\pm .010$ AFTER PLATING
- 2) MALE RF CONNECTORS AVAILABLE UPON REQUEST
- 3) INTERPRET DRAWING PER ASME Y14.5M-1994

TYPE	A	B	C	D
3	.870	.449	.336	.800
4	1.070	.649	.536	1.000
5	1.270	.849	.736	1.200
6	1.470	1.049	.936	1.400
8	1.870	1.449	1.336	1.800

Wright Technologies Inc.

TITLE

WT 1018 SERIES